

Riciclaggio cavi elettrici e radiatori - Electric cables and radiators recycling



Riciclaggio RAEE e CAR FLUFF - W.E.E.E Recycling and CAR FLUFF



Riciclaggio metalli non ferrosi - Non-ferrous metals recycling



Riciclaggio materie plastiche - Plastics recycling



Riciclaggio inerti e vetro - Aggregates and glass recycling



Separazione densimetrica a secco - Dry densimetric separation



[www.guidettisrl.com](http://www.guidettisrl.com)



Via Salvi, 1 | 44045 Renazzo [FE] Italy | Tel. +39 051 6858511 | Fax +39 051 972099 | [info@guidettisrl.com](mailto:info@guidettisrl.com)

Guidetti s.r.l. si riserva il diritto di apportare modifiche ai prodotti in qualsiasi momento, anche senza preavviso. È vietata la riproduzione, anche parziale, del materiale qui contenuto se non autorizzata.  
 Guidetti s.r.l. reserves the right to make changes to its products at any time, including without notice. Unauthorised reproduction, including partial, of the contents of this document is forbidden.  
 Guidetti s.r.l. se réserve le droit de modifier à tout moment les produits, même sans préavis. La reproduction, même partielle, du matériel contenu dans ce manuel est interdite, à moins d'une autorisation préalable.  
 Guidetti s.r.l. se reserva el derecho a aportar modificaciones a los productos en cualquier momento, incluso sin preaviso. Está prohibida la reproducción, incluso parcial, del material aquí contenido si no ha sido previamente autorizada.  
 Die Guidetti s.r.l. behält sich vor, jederzeit Änderungen auch ohne Vorankündigung an den Produkten vorzunehmen. Der auch teilweise Nachdruck ohne Genehmigung ist untersagt.



**GUIDETTI**  
RECYCLING SYSTEMS

proudly  
made in italy

MACCHINE  
PER IL RECUPERO  
DIFFERENZIATO  
DA SCARTI E  
SFRIDI  
INDUSTRIALI

MACHINES  
FOR INDUSTRIAL  
SCRAPS  
RECYCLING

# LINEA MRP



[www.guidettisrl.com](http://www.guidettisrl.com)



**Misto metalli. Pezzatura fino a 50 mm.**  
Mixed metals. Pieces up to 50 mm size.  
Métaux mélangés. Dimension jusqu'à 50 mm.  
Metales mixtos. Tamaño hasta 50 mm.  
Gemischte Metalle. Korngröße bis 50 mm.



**Misto metalli. Pezzatura fino a 35 mm.**  
Mixed metals. Pieces up to 35 mm size.  
Métaux mélangés. Dimension jusqu'à 35 mm.  
Metales mixtos. Tamaño hasta 35 mm.  
Gemischte Metalle. Korngröße bis 35 mm.



**Misto metalli. Pezzatura fino a 20 mm.**  
Mixed metals. Pieces up to 20 mm size.  
Métaux mélangés. Dimension jusqu'à 20 mm.  
Metales mixtos. Tamaño hasta 20 mm.  
Gemischte Metalle. Korngröße bis 20 mm.



**Misto metalli. Pezzatura fino a 10 mm.**  
Mixed metals. Pieces up to 10 mm size.  
Métaux mélangés. Dimension jusqu'à 10 mm.  
Metales mixtos. Tamaño hasta 10 mm.  
Gemischte Metalle. Korngröße bis 10 mm.



**Frazione non metallica.**  
Non-metallic fraction.  
Fraction sans métal.  
Fracción sin metales.  
Nicht-metallische Fraktion.

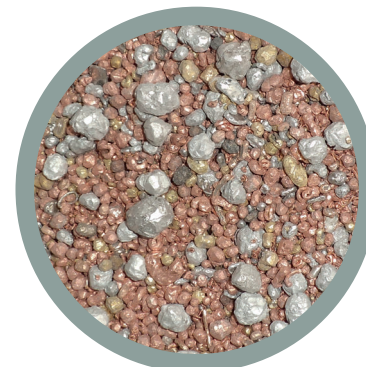

**Misto rame, alluminio, bronzo, etc.**  
Copper, aluminum, bronze, etc.  
Mélange de cuivre, aluminium, bronze etc.  
Mezcla de Cobre, aluminio, bronce etc.  
Gemischte Kupfer, Aluminium, Bronze, usw.

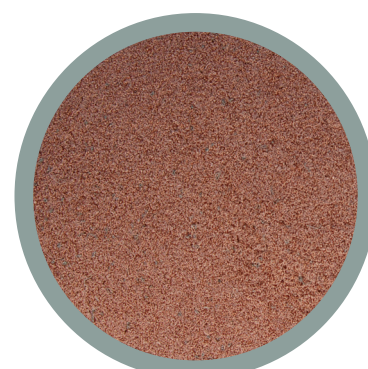

**Polveri di metallo fino a 0,8 mm.**  
Metal's dust up to 0,8 mm size.  
Poudres de métaux jusqu'à 0,8 mm.  
Polvo de metales hasta 0,8 mm de tamaño.  
Metallpulver bis zu 0,8 mm.

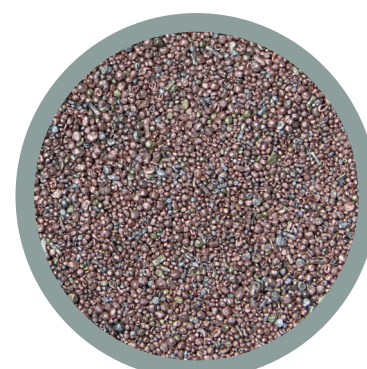

**Misto metalli da 0,8 mm.**  
Mixture of metals from 0,8 mm size.  
Mélange métaux de 0,8 mm.  
Mezcla de metales de 0,8 mm de tamaño.  
Gemischte Metalle von 0,8 mm.

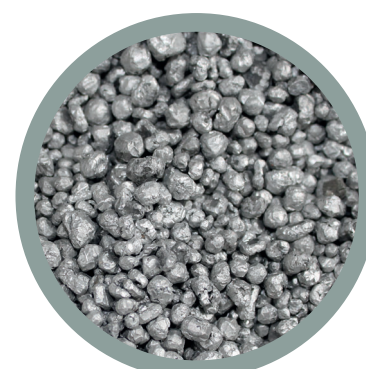

**Alluminio puro.**  
Pure Aluminum.  
Aluminium pure.  
Aluminio puro.  
Reines Aluminium.

## LINEA MRP 560 – 680

### 1 DOSING CONVEYOR ND 600

Descrizione	General data
Hopper capacity	1.2 m <sup>3</sup>
Installed power	1.4 kW (1.9 HP)
Total weight	890 kg

### 2 CONVEYOR NT 400

Descrizione	General data
Weigh	400 KG
Electric motor Gearbox	0.75 kW

### 3 SEPARATOR ZIG ZAG

Descrizione	General data Z30
Installed power	1.5 kW

### 4 HAMMER MILL MK560- MH560 (HYBRID VERSION)

Descrizione	General data MK560	General data MH560
Mill mass	1.400	1.200
Installed power	75 kW	55 kW

### 4I HAMMER MILL MK680 - MH680 (HYBRID VERSION)

Descrizione	General data MK680	General data MH680
Mill mass	4.350	4.200
Installed power	132 kW	110 kW

## START PROCESS

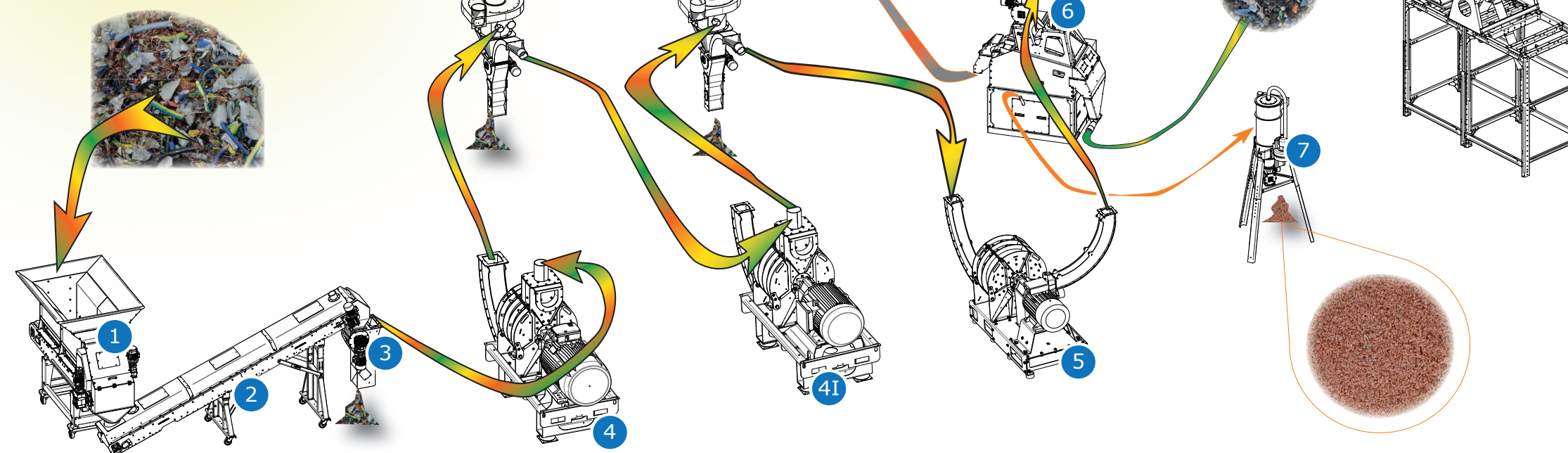

## END PROCESS

### 5 TURBO T625-2 – T625-4

Descrizione	General data T625-2	General data T625-4
Mass	1.500 Kg	1.700 Kg
Electric motor	kW 37	kW 75

### 6 SEPARATOR ROBI 71 – 151

Descrizione	General data ROBI 71	General data ROBI 151
Installed power	3,5 kW	5 kW
Total weight	830 kg	1.070 kg

### 7 METAL DUST ASPIRATOR

Descrizione	FOR ROBI
Installed power	2.5 kW
Total weight	210 kg

### 8 MULTITABLE F15MT

Descrizione	General data
Installed power	5,2 kW
Total weight	1.075kg